



MAXXIOM  
POWER SOLUTIONS



MAXXIOM POWER BOX – BLUE HEELER MKII

# MAXXIOM POWER BOX – BLUE HEELER MK II - 5kW WITH 10KWH BATTERY

| Solar Generation       |                                   |
|------------------------|-----------------------------------|
| Number of Solar Panels | 12 – Recommended (3S/2P per MPPT) |
| Panel Size (Watts)     | 440 W - Maximum                   |
| Total Solar (Watts)    | 5280 W - Maximum                  |
| Optimal Orientation    | Dual MPPT North / North West      |

| Output Solar + Battery |                                  |
|------------------------|----------------------------------|
| Output Nominal         | 5000 VA (3900 VA @ 40°C) 230 VAC |
| Peak Power             | 9000 w (10 Seconds)              |
| 10 Amp Outlet          | 2x 230 VAC                       |
| 15 Amp Outlet          | 2x 230 VAC                       |
| 15 Amp Outlet & Inlet  | 1x 230 VAC / 1x 240 VAC          |
| Usage Average per Hour | Sun: 2.5 kVa Night:0.7kVa        |

| Battery Capacity  |                                    |
|-------------------|------------------------------------|
| Battery Capacity  | 10kWh (2x 5kWh Modules) Expandable |
| Usable Capacity   | 9kWh                               |
| Runtime at 1.5kVa | 6 Hours                            |
| Runtime at 0.5kVa | 18 Hours                           |

| Dimensions mm           |                          |
|-------------------------|--------------------------|
| Power Box – Blue Heeler | W 640 x H 730 x D 545 mm |
| Battery Expansion Unit  | W 640 x H 700 x D 545 mm |

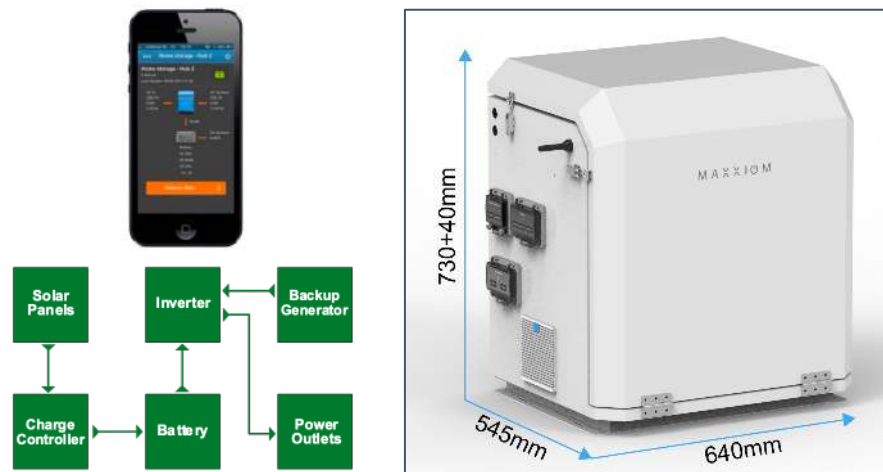

## Recommended Applications

- Off-Grid Tiny Homes, Sheds or Off-Grid 3 Bedroom Home
- Remote Power Station (Mining / Agriculture/Construction)
- Demountable Office & Accommodation Power Supply
- Remote Communities
- IP55 Rated / Passive Cooling
- 5 Years Power Equipment / 10 Years Battery Warranty

## Upgrades & Add-ons

- 4G Cellular Monitoring
- Additional 5kWh Battery
- Additional MPPT Charge Controller
- GPS Locator
- Battery Expansion Cabinet (5-15kWh Battery)
- Water Tank Sensor

**Maxxiom Power Box - Blue Heeler Mk II** is the next generation of our all-in-one ready to use ground mounted off-grid power station. Simply plug in or hard wire to an existing building or application. The system can control critical and non-critical loads for extended battery run times. Blue Heeler is almost completely self sustainable from solar generation, generator auto start and charge is built in for bad weather or higher than normal usage requirements. Active cooling can be added for high temperature sites. Blue Heeler includes remote monitoring using your own supplied Wi-Fi device or it can be supplied with Telstra 4GX or Starlink internet bundle. Battery can be expanded up to 30kWh in multiples of 10kWh with the Battery Expansion Kit. Multiple units can be combined for three phase power or increased single phase power output & storage.